



Product name : Adjustable stainless steel hinge model H3001 wingnut

Code : SWCHNG3001005

Weight : 0 kg

Dimension (LxWxH) : 4 x 4 x 10 cm

DESCRIPTION

Adjustable stainless steel hinge model **H30**. Stainless steel M6 screws.

Set composed by anti-slip sub-rosette, stainless steel screws and fixing material.

All **ARCA** hinges are interchangeable with all our toilet seats' models

TIPS FOR INSTALLATION:

If, during installation, difficulties in screwing may arise, do not strain the screw but unscrew it and then start the process again to let the hinge assembling properly.

ARCA CONCEPT S.r.l.

Via del Mella, 19/21

IT - 25131 Brescia

T. +39 030 7281057

Email: info@arcaconcept.com

www.arcaconcept.com

Product name : Adjustable stainless steel hinge H3002 vario speed

Code : SWCHNG3002005

Weight : 0 kg

Dimension (LxWxH) : 4 x 4 x 10 cm

DESCRIPTION

Adjustable stainless steel hinge model **H30**. Stainless steel M6 screws.

Set composed by anti-slip sub-rosette, stainless steel screws and fixing material.

All **ARCA** hinges are interchangeable with all our toilet seats' models

TIPS FOR INSTALLATION:

If, during installation, difficulties in screwing may arise, do not strain the screw but unscrew it and then start the process again to let the hinge assembling properly.



ARCA CONCEPT S.r.l.

Via del Mella, 19/21

IT - 25131 Brescia

T. +39 030 7281057

Email: info@arcaconcept.com

www.arcaconcept.com

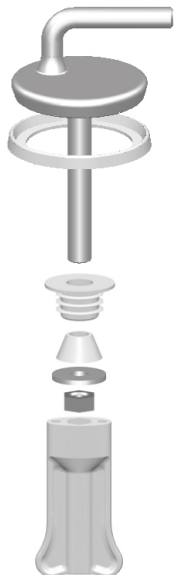

Product name : Adjustable stainless steel hinge model H3003 professional

Code : SWCHNG3003005

Weight : 0 kg

Dimension (LxWxH) : 4 x 4 x 10 cm

DESCRIPTION

Adjustable stainless steel hinge model **H30**. Stainless steel M6 screws.

Set composed by anti-slip sub-rosette, stainless steel screws and fixing material.

All **ARCA** hinges are interchangeable with all our toilet seats' models

TIPS FOR INSTALLATION:

If, during installation, difficulties in screwing may arise, do not strain the screw but unscrew it and then start the process again to let the hinge assembling properly.

ARCA CONCEPT S.r.l.

Via del Mella, 19/21

IT - 25131 Brescia

T. +39 030 7281057

Email: info@arcaconcept.com

www.arcaconcept.com

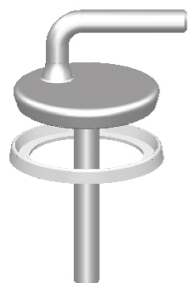

Product name : Adjustable stainless steel hinge model H3004 professional wingnut

Code : SWCHNG3004005

Weight : 0 kg

Dimension (LxWxH) : 4 x 4 x 10 cm

DESCRIPTION

Adjustable stainless steel hinge model **H30**. Stainless steel M6 screws.

Set composed by anti-slip sub-rosette, stainless steel screws and fixing material.

All **ARCA** hinges are interchangeable with all our toilet seats' models

TIPS FOR INSTALLATION:

If, during installation, difficulties in screwing may arise, do not strain the screw but unscrew it and then start the process again to let the hinge assembling properly.

ARCA CONCEPT S.r.l.

Via del Mella, 19/21

IT - 25131 Brescia

T. +39 030 7281057

Email: info@arcaconcept.com

www.arcaconcept.com