

Product name : ABS chromed double paper holder ATLA series orange

Code : BTAATL1500217

Weight : 0 kg

Dimension (LxWxH) : 9.5 x 26.5 x 6.5 cm

DESCRIPTION

ABS chromed and ABS chromed and stainless steel chromed paper holder **ATLA** collection. Ideal for those who love bright and colorful environment, ATLA series is available in many colors. This series is indeed enriched by an acrylic colored plate which allows the product to be adapted to their own taste. It can be fixed to the wall with screws or bolts, or glued with a special product to avoid drilling holes in the wall, while guaranteeing the same fixing and maximum stability.

Available colors: orange (17), purple (19), champagne (30), blue (32).

FEATURES: MADE IN ITALY, modern design, wall mounted paper holder, stainless steel, ABS chrome plated back rosette, single box packed, 5 years warranty.

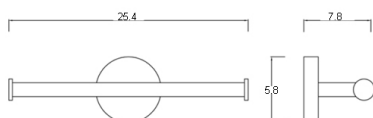
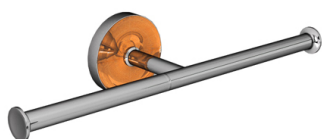

Products and accessories available



BTAATL0110217
ABS chromed soap
dish ATLA series



BTAATL0210217
ABS chromed
tumbler holder ATLA
series



BTAATL0400217
ABS chromed robe
hook ATLA series



BTAATL1000217
ABS chromed towel
ring ATLA series



BTAATL1200217
ABS chromed paper
holder ATLA



BTAATL0600217
ABS chromed towel
bar ATLA series

ARCA CONCEPT S.r.l.

Via del Mella, 19/21

IT - 25131 Brescia

T. +39 030 7281057

Email: info@arcaconcept.com

www.arcaconcept.com

Product name : ABS chromed double paper holder ATLA series purple

Code : BTAATL1500219

Weight : 0 kg

Dimension (LxWxH) : 9.5 x 26.5 x 6.5 cm

DESCRIPTION

ABS chromed and ABS chromed and stainless steel chromed paper holder **ATLA** collection. Ideal for those who love bright and colorful environment, ATLA series is available in many colors. This series is indeed enriched by an acrylic colored plate which allows the product to be adapted to their own taste. It can be fixed to the wall with screws or bolts, or glued with a special product to avoid drilling holes in the wall, while guaranteeing the same fixing and maximum stability.

Available colors: orange (17), purple (19), champagne (30), blue (32).

FEATURES: MADE IN ITALY, modern design, wall mounted paper holder, stainless steel, ABS chrome plated back rosette, single box packed, 5 years warranty.

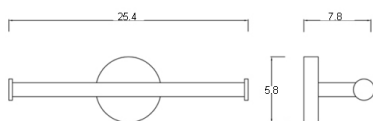
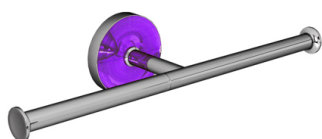

Products and accessories available



BTAATL0110217
ABS chromed soap
dish ATLA series



BTAATL0210217
ABS chromed
tumbler holder ATLA
series



BTAATL0400217
ABS chromed robe
hook ATLA series



BTAATL1000217
ABS chromed towel
ring ATLA series



BTAATL1200217
ABS chromed paper
holder ATLA



BTAATL0600217
ABS chromed towel
bar ATLA series

ARCA CONCEPT S.r.l.

Via del Mella, 19/21

IT - 25131 Brescia

T. +39 030 7281057

Email: info@arcaconcept.com

www.arcaconcept.com

Product name : ABS chromed double paper holder ATLA series champagne

Code : BTAATL1500230

Weight : 0 kg

Dimension (LxWxH) : 9.5 x 26.5 x 6.5 cm

DESCRIPTION

ABS chromed and ABS chromed and stainless steel chromed paper holder **ATLA** collection. Ideal for those who love bright and colorful environment, ATLA series is available in many colors. This series is indeed enriched by an acrylic colored plate which allows the product to be adapted to their own taste. It can be fixed to the wall with screws or bolts, or glued with a special product to avoid drilling holes in the wall, while guaranteeing the same fixing and maximum stability.

Available colors: orange (17), purple (19), champagne (30), blue (32).

FEATURES: MADE IN ITALY, modern design, wall mounted paper holder, stainless steel, ABS chrome plated back rosette, single box packed, 5 years warranty.

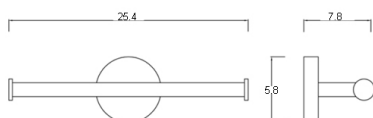
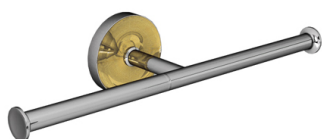

Products and accessories available



BTAATL0110217
ABS chromed soap
dish ATLA series



BTAATL0210217
ABS chromed
tumbler holder ATLA
series



BTAATL0400217
ABS chromed robe
hook ATLA series



BTAATL1000217
ABS chromed towel
ring ATLA series



BTAATL1200217
ABS chromed paper
holder ATLA



BTAATL0600217
ABS chromed towel
bar ATLA series

ARCA CONCEPT S.r.l.

Via del Mella, 19/21

IT - 25131 Brescia

T. +39 030 7281057

Email: info@arcaconcept.com

www.arcaconcept.com

Product name : ABS chromed double paper holder ATLA series blue

Code : BTAATL1500232

Weight : 0 kg

Dimension (LxWxH) : 9.5 x 26.5 x 6.5 cm

DESCRIPTION

ABS chromed and ABS chromed and stainless steel chromed paper holder **ATLA** collection. Ideal for those who love bright and colorful environment, ATLA series is available in many colors. This series is indeed enriched by an acrylic colored plate which allows the product to be adapted to their own taste. It can be fixed to the wall with screws or bolts, or glued with a special product to avoid drilling holes in the wall, while guaranteeing the same fixing and maximum stability.

Available colors: orange (17), purple (19), champagne (30), blue (32).

FEATURES: MADE IN ITALY, modern design, wall mounted paper holder, stainless steel, ABS chrome plated back rosette, single box packed, 5 years warranty.

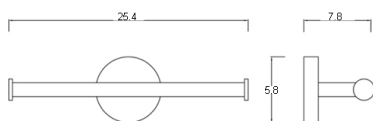
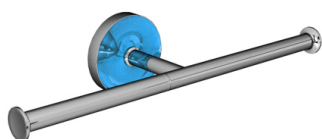

Products and accessories available



BTAATL0110217
ABS chromed soap
dish ATLA series



BTAATL0210217
ABS chromed
tumbler holder ATLA
series



BTAATL0400217
ABS chromed robe
hook ATLA series



BTAATL1000217
ABS chromed towel
ring ATLA series



BTAATL1200217
ABS chromed paper
holder ATLA



BTAATL0600217
ABS chromed towel
bar ATLA series

ARCA CONCEPT S.r.l.

Via del Mella, 19/21

IT - 25131 Brescia

T. +39 030 7281057

Email: info@arcaconcept.com

www.arcaconcept.com