



Product name : ABS built-in body jet TWIST ROUND_85 series

Code : BDJTWf0850305

Weight : 0.15 kg

Dimension (LxWxH) : 10 x 12 x 14 cm

DESCRIPTION

Brass/ABS chrome plated built-in lateral body, 1 water jet with rotating mechanism, **TWIST** collection. This round shape Ø 85 mm, thickness 12 mm.

FEATURES: MADE IN ITALY, modern design, brass/ABS chrome plated, wall application, round shape Ø 85 mm, rotating mechanism, 12 mm thickness, 1/2"G connection, 5 years warranty, box single packed.

Products and accessories available



BDJTWS8080305

ABS built-in body jet TWIST
SQUARE_80 series



BDJTWR8080305

ABS built-in body jet TWIST
ROUND_80 series



BDJTWF8585305

ABS built-in body jet TWIST
SQUARE_85series

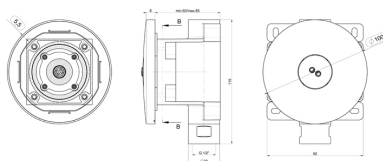

ARCA CONCEPT S.r.l.

Via del Mella, 19/21

IT - 25131 Brescia

T. +39 030 7281057

Email: info@arcaconcept.com

www.arcaconcept.com