



Product name : Special duroplast WC seat NIZZA series with H0001 hinge

Code : SWCNIH0001101

Weight : 2.3 kg

Dimension (LxWxH) : 40 x 46 x 5 cm

DESCRIPTION

White duroplast special toilet seat, model **NIZZA**, net weight 2,30 kg. Fixing material included in the package.

For further technical details, see downloadable sheet.

TIPS FOR CLEANING: wash with warm water and dry with soft cloth. The product, although resistant to chemicals, may get damaged.

YOU DO NOT KNOW WHICH TOILET SEAT USE FOR YOUR BATHROOM?

Download our Technical Guide to find your toilet seat and if you are still unsure call us!

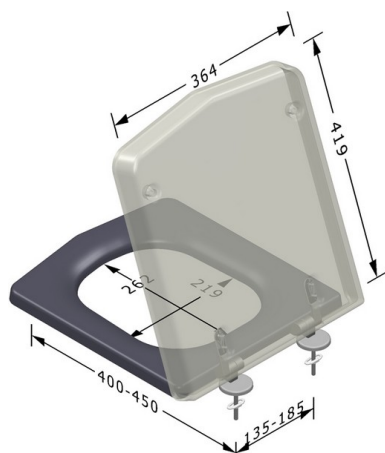

ARCA CONCEPT S.r.l.

Via del Mella, 19/21

IT - 25131 Brescia

T. +39 030 7281057

Email: info@arcaconcept.com

www.arcaconcept.com

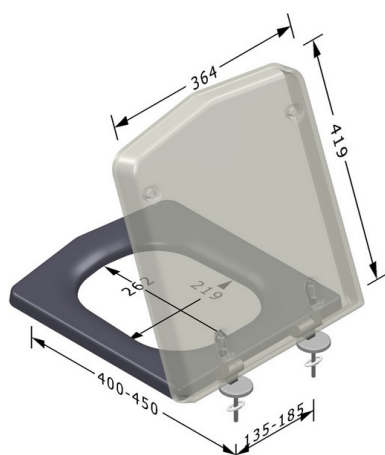

Product name : special duroplast WC seat NIZZA series with H0406 hinge

Code : SWCNIH0406101

Weight : 2.3 kg

Dimension (LxWxH) : 40 x 46 x 5 cm

DESCRIPTION

White duroplast special toilet seat, model **NIZZA**, net weight 2,30 kg. Fixing material included in the package.

For further technical details, see downloadable sheet.

TIPS FOR CLEANING: wash with warm water and dry with soft cloth. The product, although resistant to chemicals, may get damaged.

YOU DO NOT KNOW WHICH TOILET SEAT USE FOR YOUR BATHROOM?

Download our Technical Guide to find your toilet seat and if you are still unsure call us!

ARCA CONCEPT S.r.l.

Via del Mella, 19/21

IT - 25131 Brescia

T. +39 030 7281057

Email: info@arcaconcept.com

www.arcaconcept.com



Product name : special duroplast WC seat NIZZA series with H7A01 hinge

Code : SWCNIH7A01101

Weight : 2.3 kg

Dimension (LxWxH) : 40 x 46 x 5 cm

DESCRIPTION

White duroplast special toilet seat, model **NIZZA**, net weight 2,30 kg. Fixing material included in the package.

For further technical details, see downloadable sheet.

TIPS FOR CLEANING: wash with warm water and dry with soft cloth. The product, although resistant to chemicals, may get damaged.

YOU DO NOT KNOW WHICH TOILET SEAT USE FOR YOUR BATHROOM?

Download our Technical Guide to find your toilet seat and if you are still unsure call us!

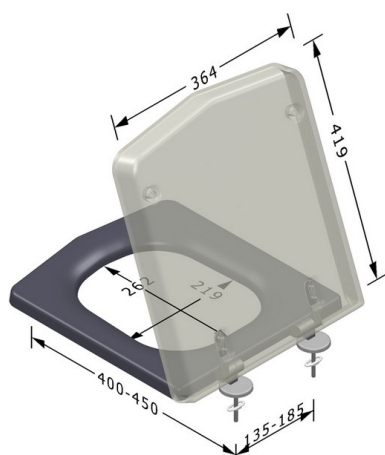

ARCA CONCEPT S.r.l.

Via del Mella, 19/21

IT - 25131 Brescia

T. +39 030 7281057

Email: info@arcaconcept.com

www.arcaconcept.com



Product name : special duroplast WC seat NIZZA series with H7A01 hinge

Code : SWCNIH7C01101

Weight : 2.3 kg

Dimension (LxWxH) : 40 x 46 x 5 cm

DESCRIPTION

White duroplast special toilet seat, model **NIZZA**, net weight 2,30 kg. Fixing material included in the package.

For further technical details, see downloadable sheet.

TIPS FOR CLEANING: wash with warm water and dry with soft cloth. The product, although resistant to chemicals, may get damaged.

YOU DO NOT KNOW WHICH TOILET SEAT USE FOR YOUR BATHROOM?

Download our Technical Guide to find your toilet seat and if you are still unsure call us!

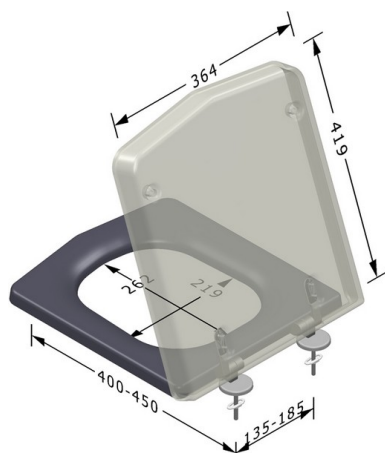

ARCA CONCEPT S.r.l.

Via del Mella, 19/21

IT - 25131 Brescia

T. +39 030 7281057

Email: info@arcaconcept.com

www.arcaconcept.com

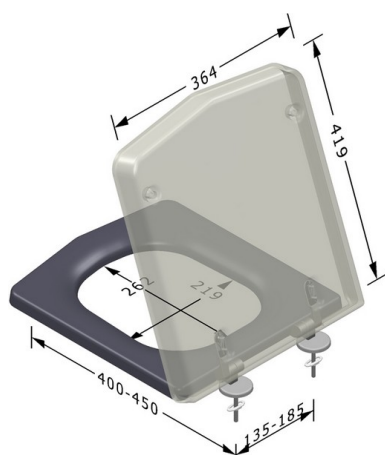

Product name : Special duroplast WC seat NIZZA series with H2501 hinge

Code : SWCNIH2501101

Weight : 2.3 kg

Dimension (LxWxH) : 40 x 46 x 5 cm

DESCRIPTION

White duroplast special toilet seat, model **NIZZA**, net weight 2,30 kg. Fixing material included in the package.

For further technical details, see downloadable sheet.

TIPS FOR CLEANING: wash with warm water and dry with soft cloth. The product, although resistant to chemicals, may get damaged.

YOU DO NOT KNOW WHICH TOILET SEAT USE FOR YOUR BATHROOM?

Download our Technical Guide to find your toilet seat and if you are still unsure call us!

ARCA CONCEPT S.r.l.

Via del Mella, 19/21

IT - 25131 Brescia

T. +39 030 7281057

Email: info@arcaconcept.com

www.arcaconcept.com

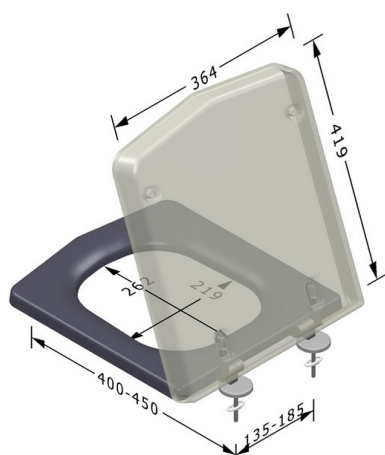

Product name : Special duroplast WC seat NIZZA series with H3001 hinge

Code : SWCNIH3001101

Weight : 2.3 kg

Dimension (LxWxH) : 40 x 46 x 5 cm

DESCRIPTION

White duroplast special toilet seat, model **NIZZA**, net weight 2,30 kg. Fixing material included in the package.

For further technical details, see downloadable sheet.

TIPS FOR CLEANING: wash with warm water and dry with soft cloth. The product, although resistant to chemicals, may get damaged.

YOU DO NOT KNOW WHICH TOILET SEAT USE FOR YOUR BATHROOM?

Download our Technical Guide to find your toilet seat and if you are still unsure call us!

ARCA CONCEPT S.r.l.

Via del Mella, 19/21

IT - 25131 Brescia

T. +39 030 7281057

Email: info@arcaconcept.com

www.arcaconcept.com



Product name : Special duroplast WC seat NIZZA series with H3301 hinge

Code : SWCNIH3301101

Weight : 2.3 kg

Dimension (LxWxH) : 40 x 46 x 5 cm

DESCRIPTION

White duroplast special toilet seat, model **NIZZA**, net weight 2,30 kg. Fixing material included in the package.

For further technical details, see downloadable sheet.

TIPS FOR CLEANING: wash with warm water and dry with soft cloth. The product, although resistant to chemicals, may get damaged.

YOU DO NOT KNOW WHICH TOILET SEAT USE FOR YOUR BATHROOM?

Download our Technical Guide to find your toilet seat and if you are still unsure call us!

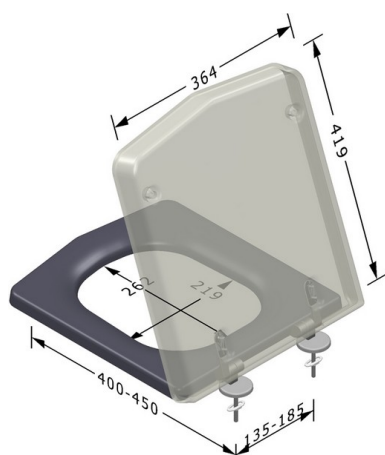

ARCA CONCEPT S.r.l.

Via del Mella, 19/21

IT - 25131 Brescia

T. +39 030 7281057

Email: info@arcaconcept.com

www.arcaconcept.com

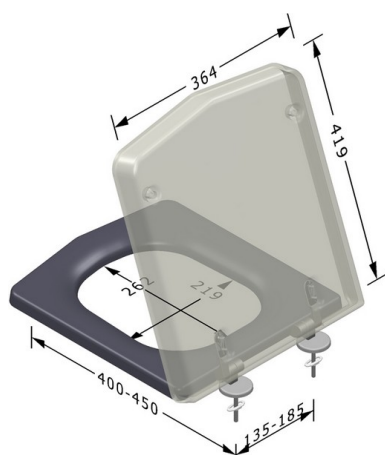

Product name : Special duroplast WC seat NIZZA series with H3506 hinge

Code : SWCNIH3506101

Weight : 2.3 kg

Dimension (LxWxH) : 40 x 46 x 5 cm

DESCRIPTION

White duroplast special toilet seat, model **NIZZA**, net weight 2,30 kg. Fixing material included in the package.

For further technical details, see downloadable sheet.

TIPS FOR CLEANING: wash with warm water and dry with soft cloth. The product, although resistant to chemicals, may get damaged.

YOU DO NOT KNOW WHICH TOILET SEAT USE FOR YOUR BATHROOM?

Download our Technical Guide to find your toilet seat and if you are still unsure call us!

ARCA CONCEPT S.r.l.

Via del Mella, 19/21

IT - 25131 Brescia

T. +39 030 7281057

Email: info@arcaconcept.com

www.arcaconcept.com

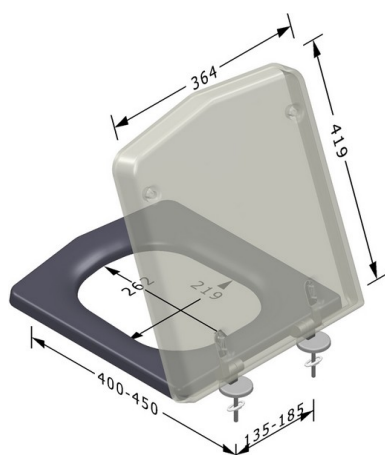

Product name : Special duroplast WC seat NIZZA series with H3806 hinge

Code : SWCNIH3806101

Weight : 2.3 kg

Dimension (LxWxH) : 40 x 46 x 5 cm

DESCRIPTION

White duroplast special toilet seat, model **NIZZA**, net weight 2,30 kg. Fixing material included in the package.

For further technical details, see downloadable sheet.

TIPS FOR CLEANING: wash with warm water and dry with soft cloth. The product, although resistant to chemicals, may get damaged.

YOU DO NOT KNOW WHICH TOILET SEAT USE FOR YOUR BATHROOM?

Download our Technical Guide to find your toilet seat and if you are still unsure call us!

ARCA CONCEPT S.r.l.

Via del Mella, 19/21

IT - 25131 Brescia

T. +39 030 7281057

Email: info@arcaconcept.com

www.arcaconcept.com



Product name : Special duroplast WC seat NIZZA series with H5001 hinge

Code : SWCNIH5001101

Weight : 2.3 kg

Dimension (LxWxH) : 40 x 46 x 5 cm

DESCRIPTION

White duroplast special toilet seat, model **NIZZA**, net weight 2,30 kg. Fixing material included in the package.

For further technical details, see downloadable sheet.

TIPS FOR CLEANING: wash with warm water and dry with soft cloth. The product, although resistant to chemicals, may get damaged.

YOU DO NOT KNOW WHICH TOILET SEAT USE FOR YOUR BATHROOM?

Download our Technical Guide to find your toilet seat and if you are still unsure call us!

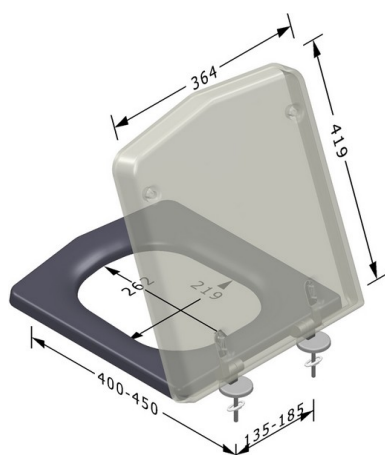

ARCA CONCEPT S.r.l.

Via del Mella, 19/21

IT - 25131 Brescia

T. +39 030 7281057

Email: info@arcaconcept.com

www.arcaconcept.com

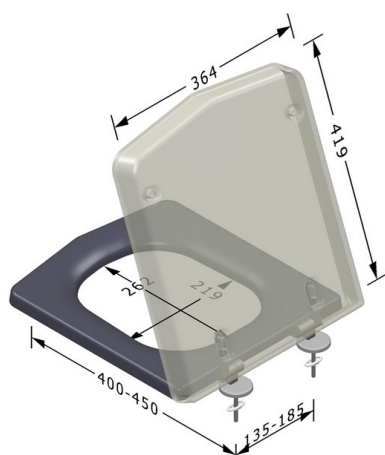

Product name : Special duroplast WC seat NIZZA series with H5101 hinge

Code : SWCNIH5101101

Weight : 2.3 kg

Dimension (LxWxH) : 40 x 46 x 5 cm

DESCRIPTION

White duroplast special toilet seat, model **NIZZA**, net weight 2,30 kg. Fixing material included in the package.

For further technical details, see downloadable sheet.

TIPS FOR CLEANING: wash with warm water and dry with soft cloth. The product, although resistant to chemicals, may get damaged.

YOU DO NOT KNOW WHICH TOILET SEAT USE FOR YOUR BATHROOM?

Download our Technical Guide to find your toilet seat and if you are still unsure call us!

ARCA CONCEPT S.r.l.

Via del Mella, 19/21

IT - 25131 Brescia

T. +39 030 7281057

Email: info@arcaconcept.com

www.arcaconcept.com

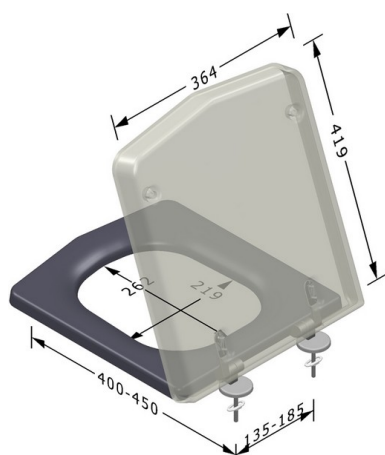

Product name : Special duroplast WC seat NIZZA series with H6001 hinge

Code : SWCNIH6001101

Weight : 2.3 kg

Dimension (LxWxH) : 40 x 46 x 5 cm

DESCRIPTION

White duroplast special toilet seat, model **NIZZA**, net weight 2,30 kg. Fixing material included in the package.

For further technical details, see downloadable sheet.

TIPS FOR CLEANING: wash with warm water and dry with soft cloth. The product, although resistant to chemicals, may get damaged.

YOU DO NOT KNOW WHICH TOILET SEAT USE FOR YOUR BATHROOM?

Download our Technical Guide to find your toilet seat and if you are still unsure call us!

ARCA CONCEPT S.r.l.

Via del Mella, 19/21

IT - 25131 Brescia

T. +39 030 7281057

Email: info@arcaconcept.com

www.arcaconcept.com